



OWNER'S MANUAL

Instructions for the **JUGS 101™** Baseball Pitching Machine

Part No. Z7101



SAVE THIS MANUAL

**ATTENTION,
Coaches and operators
of this 101 Baseball Pitching Machine:**

This manual must be kept with this pitching machine
AT ALL TIMES.

Each coach and/or operator
must read and understand the instructions in this manual
BEFORE USING
this JUGS 101 Baseball Pitching Machine.

Call 1-800-547-6843 or 503-692-1635
if you need additional copies.

Table of Contents

Introduction	2
Product Safety Signs and Labels	3
Rules for Safe Operation	5
Electrical	8
Terminology	10
Unpacking	11
Set Up	11
Transporting	12
Operating Instructions	13-15
Fielding Practice	16
Maintenance	17
Product Specifications	18
Warranty Information	19

Introduction

Your new JUGS Pitching Machine has been checked for quality and craftsmanship. Its innovative design is backed by three decades of research, development and manufacturing experience. It has many features designed to make your practices more efficient and enjoyable. Safety, performance and dependability have been given top priority in the design of all JUGS pitching machines, making them easy to operate and maintain. With proper care, your JUGS pitching machine will give you many years of enjoyable service.

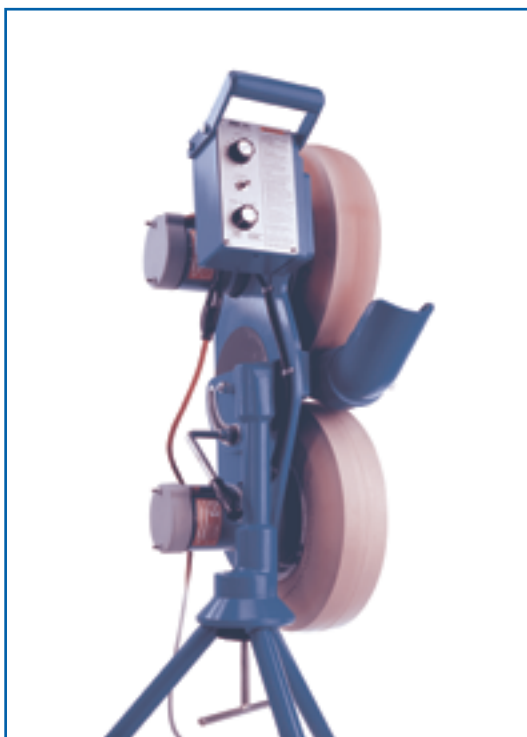

At JUGS, we are committed to providing our customers with safe, dependable products. Your comments are always welcome and they help us to continue to be the #1 producer of ball-throwing machines in the world. Call or write to JUGS, and let us know what you think.



Product Safety Signs & Labels

Safety Alert Symbols

Safety Alert Symbols indicate **DANGER**, **WARNING** or **CAUTION**. These symbols may be used in conjunction with other symbols or pictographs. Failure to obey a safety warning will result in serious injury to yourself or to others. Always follow the safety precautions to reduce the risk of electric shock and personal injury.

-  **DANGER:** Indicates an imminently hazardous situation which, if not avoided, will result in death or serious injury. This signal word is limited to the most extreme situations.
-  **WARNING:** Indicates a potentially hazardous situation which, if not avoided, could result in death or serious injury.
-  **CAUTION:** Indicates a potentially hazardous situation which, if not avoided, may result in minor or moderate injury. It may also be used to alert against unsafe practices.

Product Safety Signs and Labels

The purpose of product safety signs and labels is to draw your attention to possible dangers. The safety symbols, signal words, and the explanations with them, deserve your careful attention and understanding. The safety warnings do not by themselves eliminate any danger. The instructions or warnings they give are not substitutes for proper accident prevention measures.

Safety Signs & Labels

Carefully read all safety sign decals affixed to machine before operating your JUGS pitching machine. See examples below.





CONTROL PANEL



Figure 1

Rules For Safe Operation

-  **WARNING:** JUGS pitching machines are intended for use by operators who are at least 18 years of age and who have been instructed in their use.
-  **WARNING:** Do not attempt to operate this machine until you have read thoroughly—and understand completely—all instructions, safety rules, machine labels, etc., contained in this manual. Failure to comply can result in accidents involving electric shock or serious personal injury. Save this Owners Manual and review frequently for continuing safe operation and for instructing others who may use this machine.
-  **WARNING:** Do not connect your pitching machine to a power source until you have assembled and adjusted the machine as described in this manual and have read and understood all precautions and operating instructions in the manual and printed on the machine.

READ THIS MANUAL:

- **Know Your Pitching Machine.** Read the Owner's Manual carefully. Learn the machine's capabilities, features and limitations as well as the specific potential hazards related to this machine.
- **Guard against electrical shock.** Avoid body contact with grounded surfaces. For example, radiators, pipes, fences, or other enclosures.
- **Keep the operator's area free of clutter.** Pick up all loose balls around the machine and keep ball supply in a pail, bucket or other suitable container. Cluttered operating areas invite accidents.
- **Do not allow children to operate the pitching machine. You must be at least 18 years of age or older** and instructed in the proper operation, maintenance, care, and storage of this machine before operating it. Close supervision is necessary when this machine is used near children.

- **Use the right ball.** Use only JUGS dimpled-style, Lite-Flite, Softie, one-ounce polyball baseballs, high-quality baseballs (9-inch Wilson A1010 equal or better), or tennis balls in this machine.
- **Inspect extension cords periodically.** Replace them if damaged.
- **Use the proper extension cord.** Make sure your extension cord is in good condition. When using an extension cord, be sure to use one heavy enough to carry the current your machine will draw. An undersized cord will cause a drop in line voltage resulting in loss of power and overheating. A wire gauge size (AWG) of at least 16 is recommended for an extension cord 25 feet or less in length. If in doubt, use the next heavier gauge. The smaller the gauge number, the heavier the cord.
- **Do not abuse the cord.** Never yank the cord to disconnect it from a receptacle. Keep cord away from heat, oil, and sharp edges. Stay constantly aware of the cord's location, and keep it well away from the rotating tires.
- **Dress properly.** Do not wear loose clothing, gloves, neckties, rings, bracelets, or other jewelry. They can get caught and draw you into the moving parts. Long hair should be tied up and tucked under hats and helmets. Severe physical harm may result if loose clothing, jewelry or hair is caught in rotating tires.
- **Always wear safety glasses and batting helmets while the wheels are rotating.** Debris on the tires can fly off and cause physical harm. Everyday eyeglasses have only one-impact-resistant lenses; they are NOT safety glasses.
- **Never touch rotating tires.** Do not put hands or fingers into the ball feed chute. Hands and fingers should only go to the edge of the chute (or the edge of the sleeves in the case of fly ball or pop-up practice).
- **Inspect the machine before every use.** If damaged, have it repaired by a qualified JUGS service technician.
- **Inspect tires before every use.** Be sure tires are free of grit and debris before turning on the machine.

- **Do not use machine if ON/OFF switch does not work.** In the unlikely event that the switch becomes defective, have it replaced by a qualified JUGS service technician.
- **Keep the machine clean, and free of grit and dirt.** With the machine unplugged, use only a clean damp cloth for cleaning. Never use brake fluids, gasoline, petroleum-based products, or any solvents to clean the machine.
- **Tighten the T- and L-handles securely after adjusting trajectory.**
- **Protect the operator.** Place a pitcher's screen in front of the pitching machine.
- **Operate and store this pitching machine only in a clean, dry location.** Do not use outdoors if it is raining. If machine becomes wet, do not use. A potential shock hazard exists if this machine is used while or after it has become exposed to water. Hand-dry surface water from machine with a clean cloth and allow the machine to completely air-dry before its next use.
- **Avoid awkward operations and hand positions** where a sudden slip could cause your hand to move into the rotating tires. **ALWAYS** make sure you have good footing and balance.
- **Use only JUGS replacement parts when servicing.** All repairs, whether electrical or mechanical, should be made by a qualified JUGS service technician.
- **Do not operate this machine under the influence of drugs, alcohol, or any medication.**
- **Stay alert and exercise control.** Watch what you are doing and use common sense. Do not operate this machine when you are tired. Do not rush.
- **Avoid accidental starting when reconnecting to a power supply.** Always turn off the machine before disconnecting it from a power source. Never leave the machine running unattended. Turn the power off. Do not leave the machine until the tires come to a complete stop.

⚠ WARNING: Do not allow your familiarity with the machine to cause you to become careless. Remember that a careless fraction of a second is enough time to inflict severe injury to yourself or others.

SAVE THIS MANUAL. Refer to it often and use it to instruct other users. Do not loan your pitching machine to anyone who has not been instructed in its use. If you do loan your machine, be sure this manual goes with it.

Electrical

Grounding Instructions

This product must be grounded. If it should malfunction or break down, grounding provides a path of least resistance for the electric current, to reduce the risk of electrical shock. This product is equipped with a cord having an equipment-grounding plug. The plug must be connected to an appropriate outlet that is properly installed and grounded in accordance with all local codes and ordinances.

Do not modify the plug provided. If it will not fit the outlet, have the proper outlet installed by a qualified electrician. Improper connection of the equipment-grounding conductor can result in a risk of electric shock. The conductor with insulation having an outer surface that is green—with or without yellow stripes—is the equipment-grounding conductor. If repair or replacement of the electric cord or plug is necessary, do not connect the equipment-grounding conductor to a live terminal.

Check with a qualified electrician or service personnel if you do not completely understand the grounding instructions, or if you are in doubt as to whether the pitching machine is properly grounded.

Extension Cords

Use only 3-wire 16 AWG or larger grounding-type extension cords that have 3-prong grounding plugs and 3-pole receptacles that accept the machine's plug. When using the machine at a considerable distance from a power source, use an extension cord heavy enough to carry the current

that the machine will draw. An undersized extension cord will cause a drop in line voltage, resulting in a loss of power and causing the motor to overheat. Only round-jacketed cords listed by Underwriter's Laboratories (UL) should be used.

When working with the machine outdoors, use an extension cord designed for outside use. This is indicated by the letters WA on the cord's jacket. Before using the extension cord, inspect it for loose or exposed wires and cut or worn insulation.

⚠ WARNING: Keep the cord away from the rotating-tire area. Repair or replace a damaged or worn cord immediately.

Electrical Connection

Your JUGS pitching machine is powered by a 90-volt motor(s). Do not operate this machine on direct current (DC). A substantial voltage drop will cause a loss of power, and the motor will overheat. If the machine does not operate when plugged into an outlet, double check the power supply. Your pitching machine will operate from a standard 110-voltage AC outlet.

This machine is intended for use on a circuit that has an outlet like the one

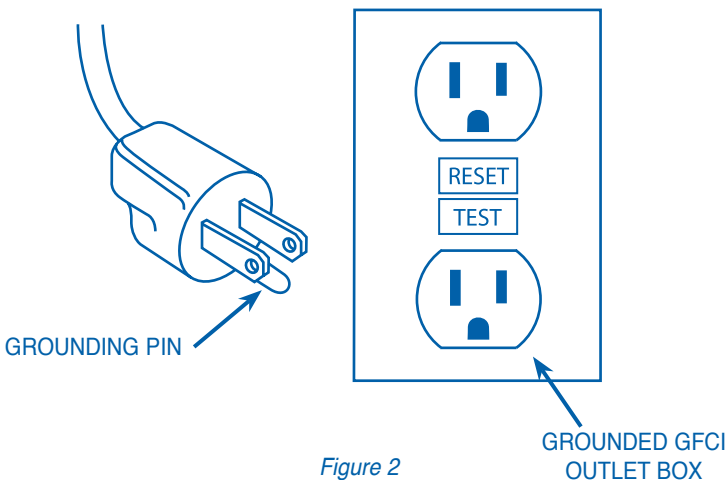

Figure 2

erminology

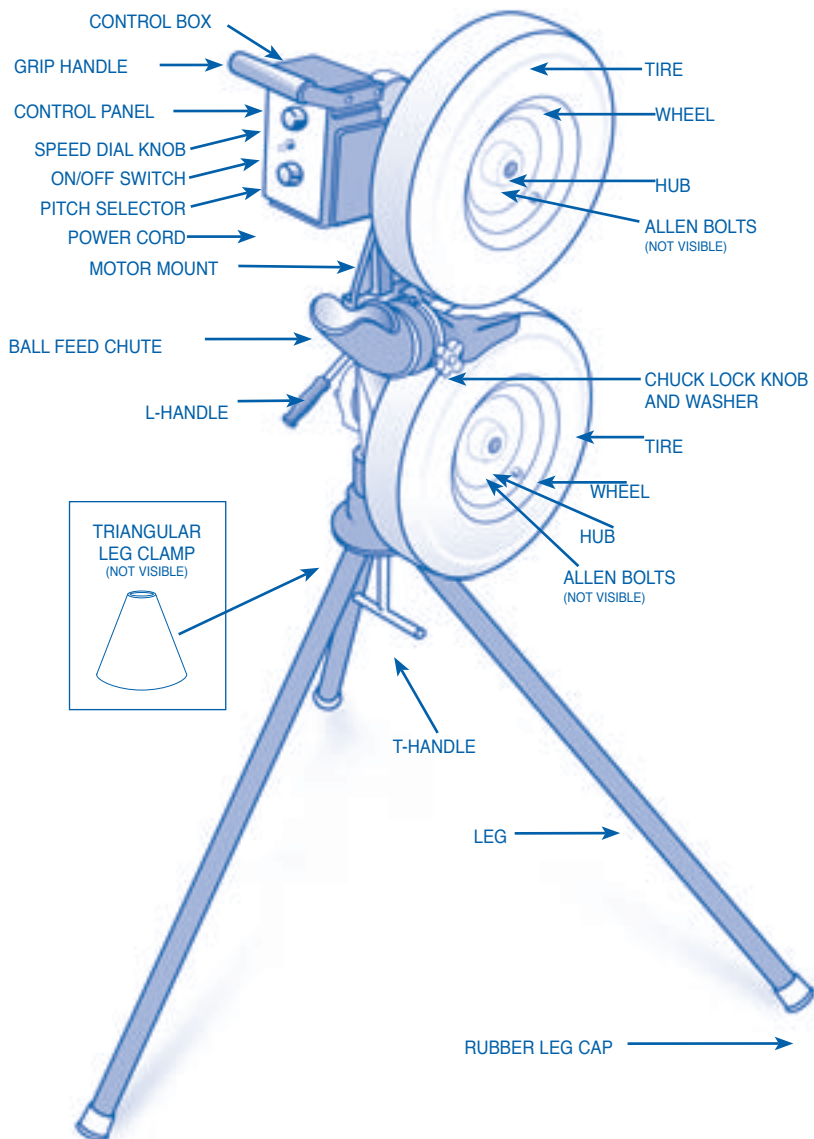

Figure 3

Unpacking

⚠ WARNING: To prevent accidental starting, or electrical shock that could cause possible serious injury, assemble all parts to your machine before connecting it to the power supply. The pitching machine should never be connected to a power supply when you are assembling parts, making adjustments, cleaning, servicing, or when you are not using it.

- Carefully lift the machine from the carton and place it on a level surface.
- Make sure you have all the parts (see nomenclature, page 10). If any parts are missing, do not operate the machine until the missing parts are replaced. Failure to do so could result in possible serious personal injury.
- Do not discard the packing materials until you have carefully inspected the machine, identified all the parts, and satisfactorily operated the machine.

NOTE: If any parts are damaged or missing, do not attempt to plug in the power cord and turn on the switch until the damaged or missing parts are obtained and are correctly installed.

Set Up

1. With the tire side down, place the triangular leg clamp in the leg clamp casting.
2. Insert the threaded end of the T-handle through the center hole in the leg clamp casting, and start the threads.
3. Install one leg in each round hole in the center piece of the leg clamp casting. Tighten the T-Handle sufficiently to hold the legs very snugly in place.

4. Place rubber leg caps on the lower ends of the legs if JUGS is to be used indoors. Leg caps are not recommended for outside use.
5. Lift the pitching machine upright.

Important:

Always set up the pitching machine so that the two legs are positioned in front, facing the pitching screen and batter, and one leg is facing back toward the operator (see photo, page 2).

⚠ WARNING: Before using the machine, the lock knob, T-Handle and L-handle must be tightened securely.

Transporting

- To move the pitching machine, slowly tip the machine over until the tires rest on the ground. Grasp and lift two legs and roll the machine on wheels to the new position as you would a wheelbarrow. The JUGS pitching machine will fit in the trunk of a car by removing its legs.
- Do not roll tires on surfaces that might damage the tire. If a tire becomes deformed, flat, or damaged, it must be repaired before using the machine. (See tire specifications, page 18.)

⚠ WARNING: Never leave the pitching machine unattended.

Operation

1. Operators of JUGS Pitching Machines must wear safety glasses and batting helmets at all times.
2. Check speed dial and make sure it is in the full counter-clockwise position (pointer at 30-mph setting) and the toggle switch is in the OFF position.
3. Plug a heavy-duty, No.16-gauge three-prong, extension cord into a 110-volt A/C outlet and connect it to the short cord on the pitching machine. Place the pitcher's screen in front of the pitching machine to protect the operator and the pitching machine from batted balls.
4. Position the machine to aim at the desired target. While grasping the handle on top of the control box, loosen the L-handle on the left side of the machine and adjust the trajectory as desired. Tighten the L-handle securely. (You will have to practice this targeting so you will know how to set the machine for each pitch.)
5. Turn the Dial-A-Pitch™ knob on your control panel to the selection feature desired.
6. Place toggle switch in the ON position. Gradually turn the speed dial to the desired speed.
7. Have all batters and observers stand well clear of the target as you throw practice balls to adjust the trajectory. Tighten the L-handle securely. (It is normal to throw five or six balls before arriving at the setting you desire.) Always have the batter and others stand clear while adjusting your JUGS pitching machine.
8. At the beginning of practice, or after any change in speed, curve, or trajectory, have the batter stand well clear while at least one test ball is thrown, to make sure the ball is thrown at the desired target. If you move the machine for any reason, repeat this process.
9. Throw balls at speeds the batter can learn to hit. As the batter's skills increase, you can throw faster pitches.

Operation

10. When you increase the speed of any pitch, you must lower the elevation of the aim; when you decrease speed, you must increase the aim elevation.
11. Space all pitches approximately six seconds apart. Try to get the batter to regard each pitch as a "separate" pitch—and not to be an "automatic" swinger.
12. Always "show" the ball to the batter. When you are certain the batter has acknowledged that he or she is ready, set the ball in the feed chute and release it. Do not drop the ball into the chute.
13. Do not permit more than one or two persons around the pitching machine during its operation.
14. Do not permit the pitching machine to fall on its wheels. This could result in non-warranted damage.
15. Check tightness of all bolts and nuts at regular intervals. If any looseness, vibration, or rattle is noticed, correct immediately before further use.
16. Always turn the speed dial to the full counter-clockwise position when throwing is completed or temporarily stopped. Then turn the toggle switch to the OFF position.

 **WARNING:** A pitching screen must be used to protect the operator and the machine from batted balls.

NOTE: We suggest that each operator spend a couple of hours experimenting with the JUGS pitching machine. Try many different speed settings. Do not be afraid that any setting you make will harm the pitching machine; however, you should use a wide backstop when experimenting with faster speeds.

IMPORTANT: If the machine becomes wet during practice, turn it off immediately, and transport it to a clean, dry location. Wipe off surface water with a soft, clean cloth and permit the machine to air dry completely before its next use.

Operation

Pitching to Batters (figure 4a):

Follow all safety performance instructions in this manual. Otherwise, physical harm to the operator (Ball Feeder) and/or the batter may result. The following feeding instructions should be used to insure accurate and efficient operation of the JUGS pitching machine.

IMPORTANT PITCHING MACHINE FEEDING INSTRUCTIONS:

- Out-of-round, soft, mushy, or wet balls will affect accuracy of pitches and must not be used. Mixing different types of balls (leather, rubber, JUGS, etc.) will affect consistency of pitches. For best accuracy, throw only one type of ball at a time.
- Use only JUGS dimpled style, Lite-Flite, Softie, one-ounce polyball baseballs, high quality leather baseballs (Wilson A1010-equal or better), or tennis balls in this machine.
- When feeding the machine with leather balls, hold the ball the same way every time. Across the seams is best, especially for curveballs.
- Have all batters and observers stand well clear of the target as you throw test balls to adjust trajectory and aiming point.
- **VERY IMPORTANT:** Before you place the ball in the feeding chute, you should look up at the batter and make absolutely sure the batter is watching you and is ready to receive the pitch. It is **EXTREMELY IMPORTANT** that you make sure that the immediate area in front of the pitching machine and the flight path of the ball is clear before you feed the balls into the pitching machine.
- When the batter has taken his/her stance and indicates he or she is ready to hit, hold the ball high in the air where the batter can see the ball. Then bring the ball down to the chute simulating live action so that the batter can time the ball correctly. Set the ball in the feed chute and release. Do not drop the ball into the chute. Watch the ball into the wheels, then look up at the batter. The whole feeding operation should be smooth and without interruption.

Operation

- Every batter, after taking his/her stance, as well as between pitches, goes through a personal readiness routine. The ball feeder should adjust the pitch spacing to each batters' habits accordingly. This will assure that the batter is ready to receive the pitch and will also help to simulate live action. The batter can then regard each throw as a separate pitch and avoid becoming an "automatic swinger". Generally speaking, pitches can be spaced between 6 and 10 seconds apart.

Tennis Balls

Tennis balls can be thrown in this machine. However, you must first inflate the tires to a pressure of 25 pounds per square inch (psi). Start with a 60-60 setting for straight balls and 50-70 for curves. (Regular curveball settings are too much for the tennis balls.) **Be sure to deflate tires to 16-17 pounds for baseball use and reset the speed dials 35 digits apart before using baseballs.**

NOTE: For Polyball (Whiffle-type only) use: Set dials no more that five (5) digits apart. Be sure to reset speed dials 35 digits apart before use with baseballs.

BATTING HELMETS MUST BE WORN AT ALL TIMES.

IMPORTANT:

If machine becomes wet during practice, turn off machine immediately, and transport it to a clean, dry location. Dry surface water with a soft, clean cloth and permit machine to completely air dry before next use.

Fielding Practice

An additional feature of your JUGS 101 pitching machine is its use for fielding practice.

Flyballs and Pop-ups (figure 4b and 4c)

- Loosen the L-handle, adjust the trajectory of the machine upward to the desired position, and then tighten the L-handle securely. The greater the upward angle, the steeper the angle the flyball or the pop-up will have. For best results, loosen the ball-chute lock knob and remove the ball chute. This will then allow you to "push" the ball into the ball sleeve.

⚠ WARNING: Keep hands and fingers away from tires and tire-side edges of the ball chute and ball sleeve. When throwing pop-ups, the operator must wear a catcher's mask as well as a batting helmet. When finished throwing flyballs and pop-ups, always reconnect the ball chute and tighten the ball chute lock knob securely.



(a) PITCHING

(b) FLYBALLS

(c) POP-UPS

(d) GROUNDERS

Figure 4

Grounders (figure 4d):

- Loosen the L-handle, adjust the trajectory of the machine downward to the desired position, and then tighten the L-handle securely. The greater the downward angle, the bigger the hop will be on the ground ball.

Maintenance

Review the following instructions carefully to maintain maximum accuracy with your JUGS Pitching Machine.

- Maintain the tire pressure at 16 to 17 pounds.

Cleaning

- **Keep the machine clean, and free of grit and dirt.** Always use a clean damp cloth when cleaning. Never use brake fluids, gasoline, petroleum-based products, or any other solvents to clean machine.
- Periodically, you must clean the tires to help maintain their maximum performance. A dirty tire can easily be distinguished by either a dark ring around the tire surface or a surface that has turned yellow and has a very glossy or shiny finish.
- Before you begin cleaning, you must first inflate the tires to approximately 17 pounds.
- Take medium-grade sandpaper (sometimes an even rougher grade is necessary, depending on the amount of soil buildup) and begin to **scrub** the tire surface as you would a very dirty frying pan. This process can be very tedious and could take up to 10 minutes per tire. However, it is necessary in order to completely clean the rubber of all foreign substances, and prepare the machine for better performance. You should sand the tires whenever you notice the soil buildup forming. **Always sand tires with the power switch turned OFF and the machine unplugged.**

Once you complete this operation, the tire surface will, in most cases, take on the white color it had originally. Maintaining the tire in this fashion will not only maximize the performance and accuracy of your machine, but it will extend the life of the tire.

Storage

- Always store machine and extension cord in separate, clean, dry, secured areas. Cover the machine with a suitable protective cover that does not retain moisture. Do not use plastic.

Product Specifications

JUGS 101™ Product Specifications:

Motor Specifications:

Variable Speed	
Maximum developed horse power	1/4 hp
Volts.....	90vDC
Amps	3 amps
Hertz.....	50/60 Hz
RPM (no load)	1900 rpm
Overload protection.....	yes

Tire Specifications:

Size.....	4.00/4.80-8
Pressure	16-17 lbs.

Frame Specifications:

Legs.....	steel tubing
Motor Mount and Leg Clamp Casting	cast aluminum
Ball Feed Chute.....	cast aluminum
Overall Height.....	69 in.
Overall Width.....	47 in.
Overall Weight.....	125 lbs.
Recommended Generator.....	Yamaha® EF1000
Recommended Balls	JUGS Balls, Wilson leather 9-inch A1010 or better

IMPORTANT:

Servicing requires extreme care and knowledge of the machine and should be performed only by JUGS. For service, we suggest you return the machine to JUGS for repair. Always use original factory replacement parts when servicing.

Warranty

JUGS Sports guarantees that the JUGS® Pitching Machines are well made; of good materials, and workmanship; and agrees that if, within five years after shipment thereof, any part so guaranteed should fail because of defective material or workmanship in its manufacture, the Company will repair or replace such part, free of charge F.O.B. to its factory in Tualatin, Oregon; provided, however, that upon request, the Buyer shall return the allegedly defective part to the Company's factory with transportation charges thereon prepaid. Commercial use of any JUGS® product automatically limits this warranty to 30 days after date of shipment.

This warranty shall not be effective if the equipment has been subject to misuse, negligence or accident, nor if the equipment has been repaired or altered outside of our Tualatin factory in any respect which, in our judgment, affects its condition or operation.

↓ **RETURN PERFORATED CARD BELOW TO JUGS SPORTS** ↓

Warranty Record

JUGS Serial No.: _____ Date Delivered: _____

Model: _____

Name: _____

Address: _____

_____ Zip: _____

Phone: (____) _____

Purchased From: _____

Type of Activity (Youth League, High School, College, etc.): _____

Coach/Manager Name: _____



In the USA and Canada, call toll-free: **1-800-547-6843**

Internationally, call collect: **0-503-692-1635**

Fax us: **503-691-1100**

Visit our website: **www.jugssports.com**

Model

Serial No.

Date Delivered

↑ SAVE THIS PORTION FOR YOUR RECORDS ↑

PLACE
STAMP
HERE

JUGS Sports
P.O. Box 365
Tualatin, Oregon 97062

**If you need
more information about
this product
or any other
JUGS product or service,
please contact
the manufacturer:**



In the USA and Canada,
call toll-free:
1-800-547-6843.

For International Orders,
call collect:
0-503-692-1635.

Our fax number is
1-503-691-1100.

Visit our website at
www.jugssports.com.

Se habla español.