

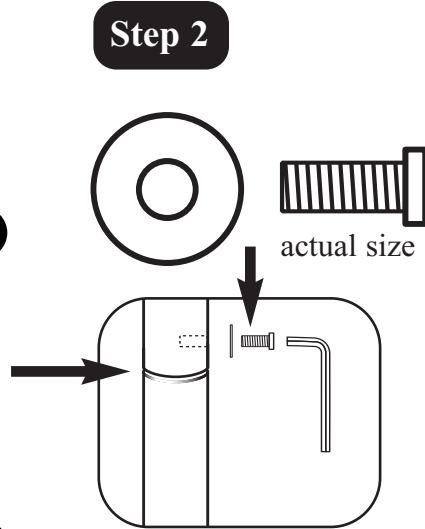

FIXED-FRAME™ L-Shaped Protective Screen Assembly Instructions

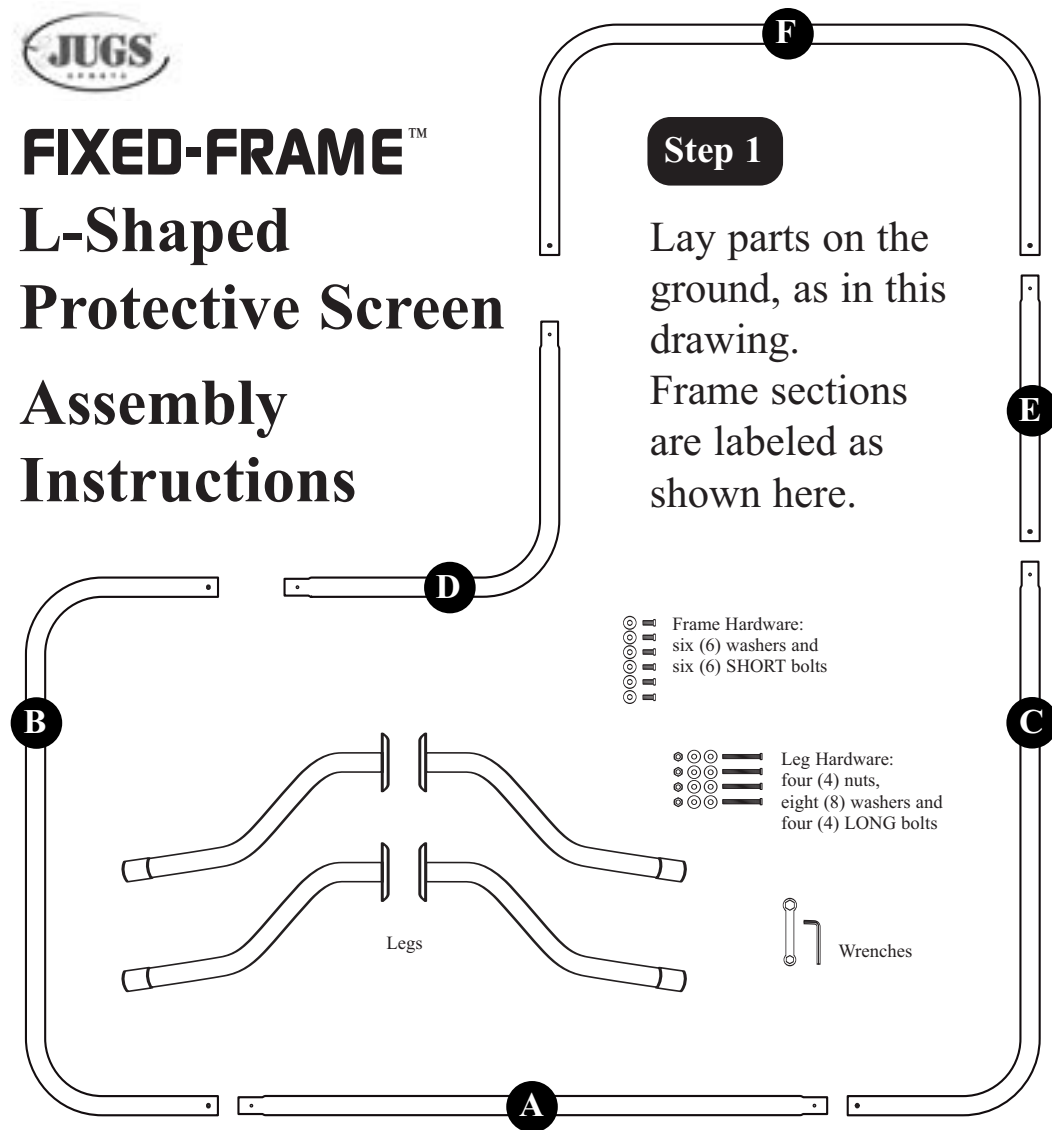

Join the frame sections. Fasten with washers and short bolts. Tighten bolts with the Allen wrench (shown in drawing).

Assembled frame size: 61/2'W x 6'H

Step 4

Carefully tilt the frame and lay it on the ground.

Stretch netting out, on the ground, in the same shape as the frame. Place the open end of the netting so it touches the top of the frame.

Stand in the center of the frame and begin feeding the netting onto the frame, like a pillowcase, alternating sides as you go. After the netting has been slipped over the frame, SECURE the netting around the bottom frame using the six (6) Velcro® strips, which are already attached to the bottom of the net.

Stand frame upright, and enjoy!

Step 3

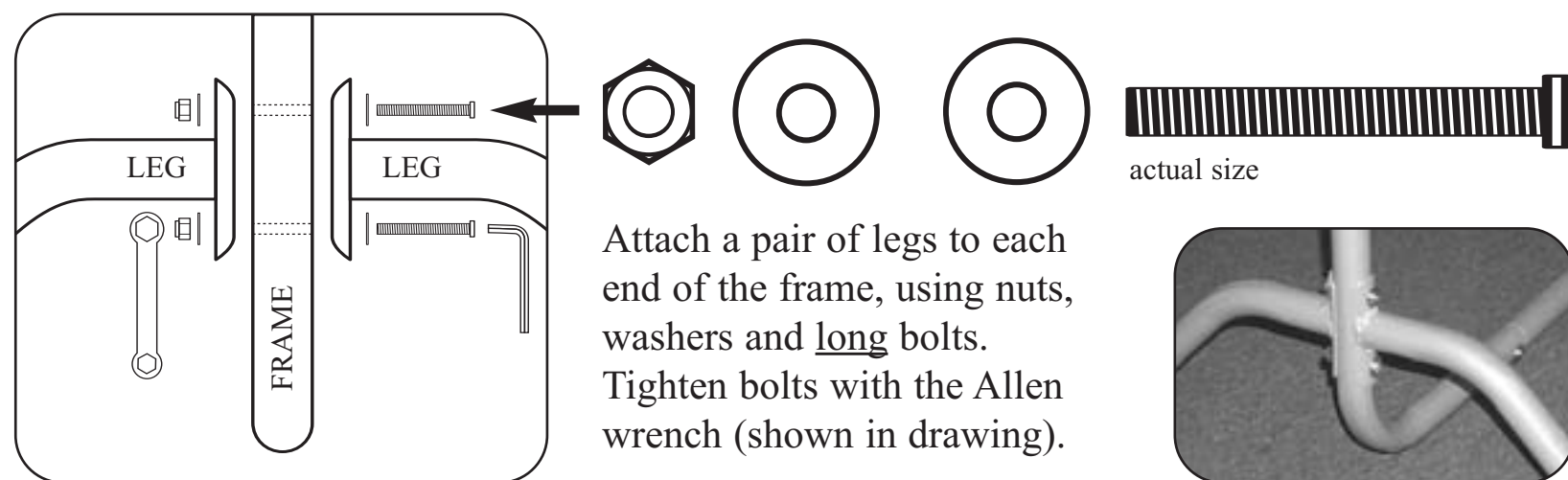

JUGS Sports guarantees JUGS Fixed-Frame™ Protective Screen netting for one (1) year against defects in material or workmanship. JUGS Fixed-Frame™ Protective Screen frames are guaranteed for one (1) year unless damaged by snow, ice or other acts of God. Commercial use of JUGS Fixed-Frame™ Protective Screens automatically limits this warranty to thirty (30) days after shipment.

If you have any questions regarding this screen, contact the manufacturer. USA or Canada, call toll free: 1-800-547-6843. International orders, call collect: 0-503-692-1635. Our fax number is 503-691-1100. Or visit our website at www.jugssports.com. © 2008 JUGS Sports LSSI-072208